

THANK YOU

For purchasing an Ecolawn Top Dresser. Your new machine has been carefully designed and manufactured to provide years of reliable and productive service. This manual will provide you with safety instructions and general maintenance tips that will help to keep your machine in top running order. Please read this manual and assembly parts carefully before assembling, operating, or servicing your equipment.

Here are 5 Ecolawn Basic Rules of Operations:

1. Use quality screened material or compost;
2. Use appropriate load size and weight;
3. Load Hopper gently to prevent loading compaction;
4. Plan the application before spreading it;
5. Test the spreader by first running it empty. A good application means preparing ahead of time. Make small adjustments in the field and eliminate major repairs.

Please visit our website or call with any questions.

Website: www.ecolawnapplicator.com

Tel: 1-866-326-5296

A good application means preparing ahead of time!

TABLE OF CONTENTS

WARRANTY	4
SAFETY INSTRUCTIONS	5
1. GENERAL	
2. GUARDS	
3. HOPPER	
4. DECALS	
OPERATING INSTRUCTIONS	6
1. PROPER TOPDRESSING	
2. OPTIMAL OPERATION	
3. MAIN USES	
USING THE ECOLAWN APPLICATOR FOR THE FIRST TIME	7
OPERATING THE ECOLAWN APPLICATOR	8
CHOOSING AN APPROPRIATE SUBSTRATE	10
1. QUALITY AND CHARACTERISTICS	
2. FRIABILITY	
3. MOISTURE CONTENT	
TROUBLESHOOTING AND ADJUSTMENTS	11
GENERAL MAINTANCE	14
1. SHAFT BEARING	
2. V-BELTS	
ASSEMBLY STEPS	15

WARRANTY | Ecolawn Applicator® One Year Limited Warranty

TERMS:

Ecolawn Applicators are guaranteed to be free of defects in materials or workmanship for one year from the registered purchase date. To qualify, the applicator must be registered online at www.ecolawnapplicator.com (under the product tab). This one-year warranty is extended only to the original, registered purchaser of the Ecolawn Applicator.

Starting from the registered purchase date, Ecolawn will replace, free of charge, any part(s) on the machine that Ecolawn or its approved agent deems to be defective in material and/or workmanship upon examination.

The warranty is limited to the Ecolawn Applicator itself. Ecolawn Applicator® is not responsible for any other equipment used with the Applicator.

SAFETY INSTRUCTIONS

This manual describes the operation of the ECO 50 Ecolawn Applicator spreader only.

1. GENERAL

- Never allow children to operate power equipment.
- Do not use the Ecolawn Applicator on any slope that is greater than 10 to 15 degrees.
- Do not modify the Ecolawn Applicator. Any alterations to the machine will void the warranty.
- Use the Ecolawn Applicator ONLY for its intended purpose.
- Keep hands and objects out of the Hopper and away from the Agitator/Mixer while the motor is running.
- Use only original Ecolawn parts to repair the Ecolawn Applicator.

2. GUARDS

Do not run the engine or operate the machine when any of the guards have been removed. This may result in severe injury and/or damage to the unit.

3. HOPPER

The Hopper's maximum load is 500 lbs (227 kg). Never exceed the maximum load capacity; this may damage the spreader.

4. DECALS

Replacement safety decals are available at no cost from Ecolawn.

OPERATING INSTRUCTIONS

1. PROPER TOPDRESSING

When topdressing, follow the same pattern you would use when mowing. Start with the sections of lawn that are farthest away from the supply source to avoid repeated traffic over the areas that have already been topdressed.

Type of Spreading Material:

- Screened compost

2. OPTIMAL OPERATION

Never exceed the maximum load capacity of the Hopper (500 lbs / 227 kg). Some substrates (such as sand or soil) are much denser than others, so it is not possible to judge load size visually. The same volume of sand or soil can weigh significantly more than compost. Overloading the Hopper may damage the spreader.

Comparative: Materials and Weights

Material Volume Weight

Compost (60% humidity) 10 cubic feet: 300 lbs

Mix Blend: 50% compost, 50% sand 10 cubic feet: 550 lbs

Sand 10 cubic feet: 800 lbs

3. MAIN USES

The Eco 50 Tow-Behind Broadcast Compost Spreader is designed to spread compost, peat moss, soil amends and seeds for lawn restoration and renovation. To learn more about compost topdressing, please visit our website at : www.ecolawnapplicator.com.

USING THE ECOLAWN APPLICATOR FOR THE FIRST TIME

Before using the spreader for the first time, make sure the Tow Bar is extended out far enough to operate the Activation Lever. While the spreader has been factory adjusted for immediate use, some minor adjustments may be necessary. We recommend the following startup procedure to ensure that the machine is properly adjusted before use.

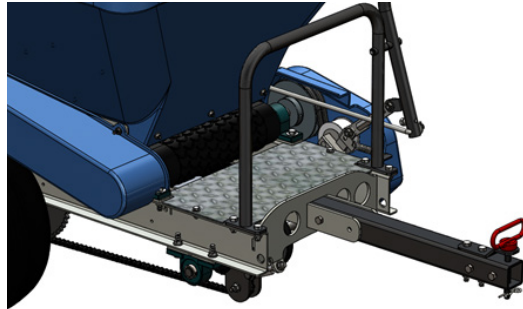

Step 1.

The spreader's belts are new, so they may not adhere perfectly to the pulleys; they may slip a little when the machine is used for the first time. Before loading the spreader with substrate, run it around empty for about 10 minutes to allow the belts to become seated properly on the pulleys.

Step 2.

Fill the Hopper to 1/3 capacity (see Page 8, Step 1), then run the spreader until empty and refill to this level for the first 3 or 4 loads.

Step 3.

Fill the Hopper to its maximum capacity (500 lbs / 227 kg) and begin using the spreader normally.

Step 4.

After 1 hour of use, visually inspect the spreader. Vibrations combined with a heavy load may occasionally cause nuts and bolts to loosen. Tighten these when necessary.

Step 5.

After 8 hours of use, inspect the nuts and bolts again and tighten if necessary. If some pulleys do not run correctly after these trials, please refer to Ecolawn Application: Troubleshooting and Adjustments.

OPERATING THE ECOLAWN APPLICATOR

Step 1.

Filling the Hopper

Before filling the Hopper, first ensure that the Feed Flap (Figure 1) is properly closed by pushing the Feed Flap Lever all the way down (Figure 2).

Fill the Hopper with the substrate to be spread. Note: Never exceed the Hopper's maximum load capacity (500 lbs / 227 kg); this can damage the machine.

FIGURE 1

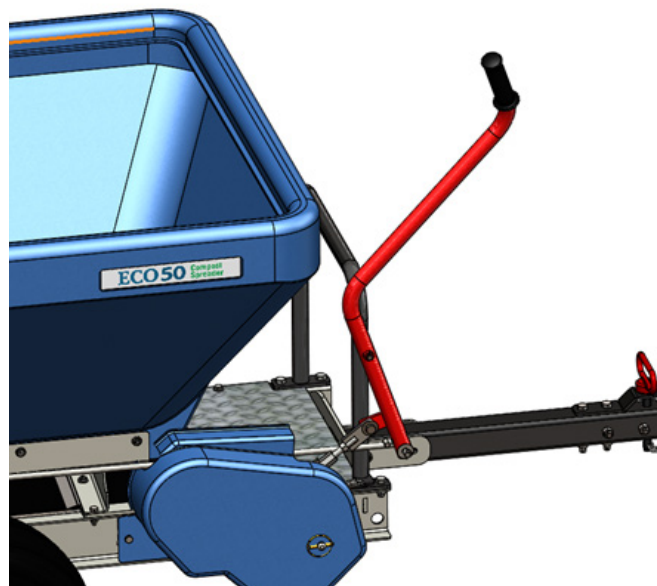
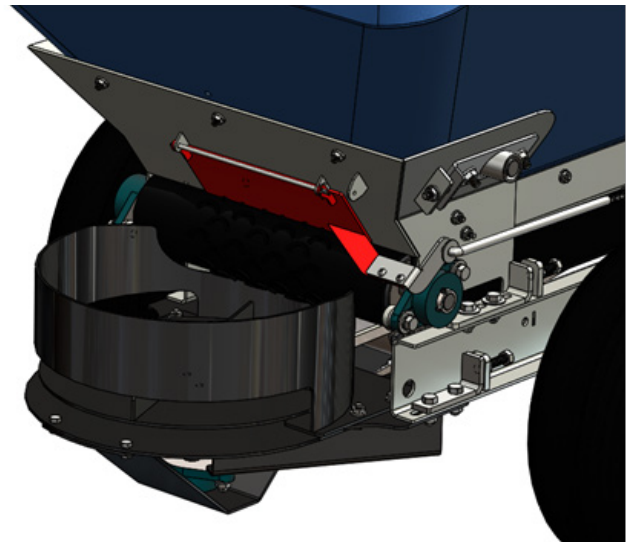

FIGURE 2

Step 2.

Starting to spread

Before pulling the Eco 50, make sure the Conveyor System is not engaged. Be sure that the Conveyor Action Lever (Figure 3) is disengaged and the Feed Flap is properly closed.



FIGURE 3

Step 3.

Topdressing with a Substrate

After loading the machine, transport to the desired location to start spreading. Before moving forward, open the Feed Flap with the lever shown in Figure 2. Pull the Conveyor Activation Lever toward you (Figure 4) to move the spreader forward and spread the substrate.

Note: The ground speed determines the width of spread.

FIGURE 4



Step 4.

Stopping the Spreader

When the Hopper is empty, release the Conveyor Activation Lever to disengage the Conveyor Belt and close the Feed Flap. If filling the Hopper again, tow the unit to the substrate source and then refill the Hopper.

CHOOSING AN APPROPRIATE SUBSTRATE

1. QUALITY AND CHARACTERISTICS

It is very important to choose a high-quality topdressing substrate. For greatest cost efficiency, Ecolawn recommends using a bulk substrate which is friable, has a moisture content lower than 65%, and contains no inorganic matter (plastic, glass, or concrete, etc.) or raw organic matter (such as pieces of wood, raw manure).

2. FRIABILITY

A friable material is one that crumbles easily into small fragments. A substrate that is not very friable appears to be composed of numerous, compact pieces which do not readily break down. Screening a substrate makes it much more friable. Additionally, a substrate containing 10% sand is more friable and will flow more smoothly and efficiently through the applicator.

3. MOISTURE CONTENT

A substrate with a moisture content greater than 65% will tend to stick to the inside walls of the Hopper and other parts of the spreader. When working with a substrate with a high moisture content, coat the insides of the Hopper and the Spreading Disk with a lubricant.

To help the substrate flow freely from the Hopper, stop the machine and loosen with shovel. This will loosen the substrate so that it can flow freely from the Hopper.

TROUBLESHOOTING AND ADJUSTMENTS

Important: Most adjustments are remedied in the field with just a few procedures.

The most frequent problems encountered involve the Conveyor, but these can easily be resolved with a few simple solutions. Check the following issues for your particular problem, and make the corresponding adjustments as needed.

Issue: The V-belts are slipping. The spreader's Hopper is full. The Conveyor has been activated by pulling the Conveyor Activation Lever toward you, but the Conveyor Belt does not work because the V-belts are slipping.

Solution: The V-belts are not tight enough. First remove the guards from the Tensioner and check the tension of the belts, which may be slipping on the pulleys that power the Conveyor Drive Roller. If the tension is incorrect, adjust it by lengthening the Tensioner Rod of the Conveyor Activation Clutch, a few turns at a time, as follows:

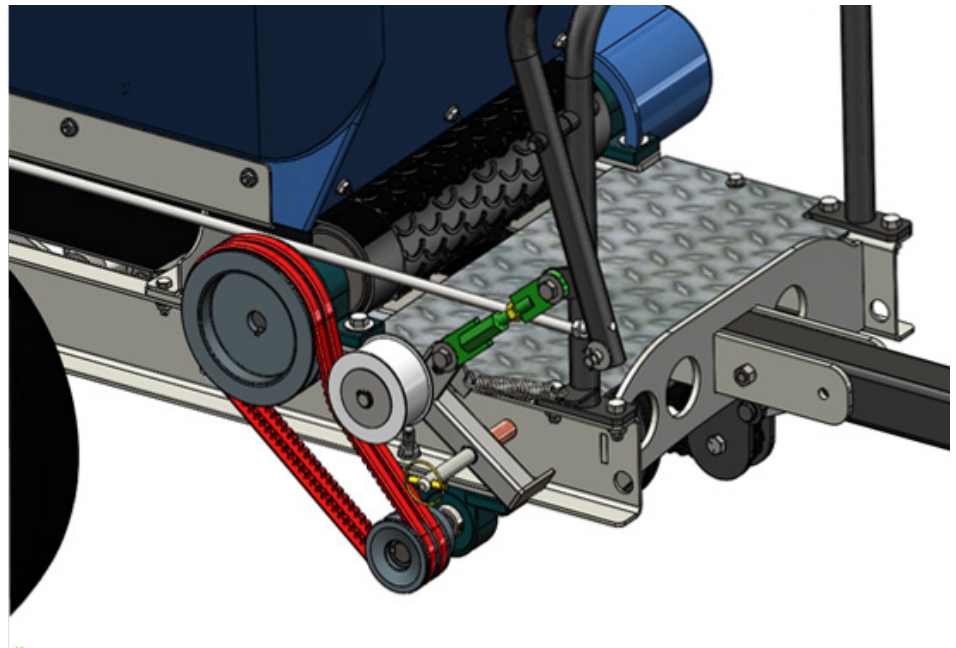

1. Loosen the (yellow) Jam Nuts to adjust the tension of the Tensioner Rod.
2. Turn the (green) Top Tensioner Adjuster to increase tension, or clockwise to reduce it.
3. Tighten the (yellow) Jam Nuts to maintain the tension at the proper level.

Issue: The spreader's Hopper is full. The Conveyor has been activated by pulling the Conveyor Activation Lever toward you, but the Conveyor Belt is not turning even though the Tensioner Rod has been adjusted properly and the Conveyor Drive Roller is turning.

Solution: Adjust the Tension Bolts of the Conveyor Belt System on each side, 1/2 turn at a time on both sides equally, to increase the tension on the Conveyor Belt. Do as follows:

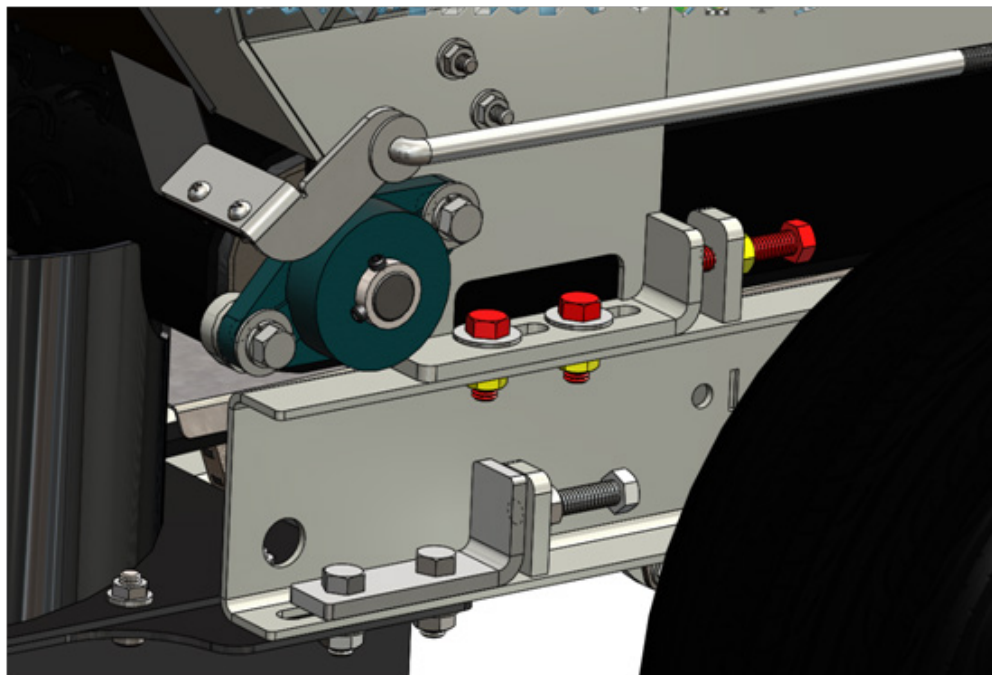

1. Loosen the 2 vertical (yellow) nuts on each side of the machine.
2. Loosen the (yellow) Jam Nut and tighten the horizontal bolt to push the Conveyor Roller forward a 1/2 turn at a time.
3. Now tighten down the 2 vertical nuts on both sides to hold the front system in place and tighten the Jam Nuts to lock the Tension Bolts.
4. Test the machine and re-adjust if necessary.

Issue: The spreader moves forward and the Conveyor works, but the Spreading Disk does not spin.

Solution: To free the disk, turn the machine off, and then turn the spinner disk backward manually to remove any debris. Visually inspect the pulleys and clean them as needed. If the pulley groove used to turn the spinner disk has collected substrate, it may cause the belt to come off. Clean out the pulley groove under the spinner, then re-mount the belt in the pulley groove.

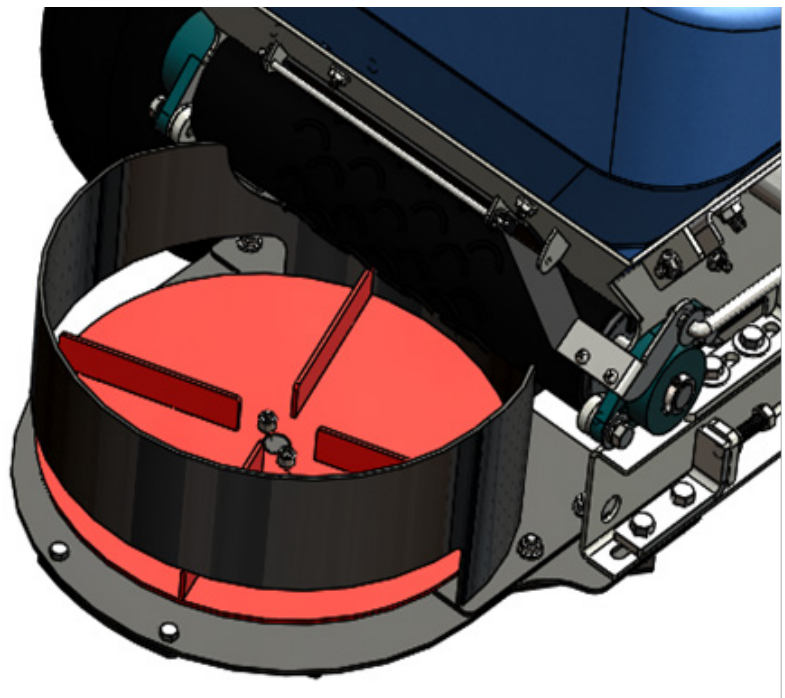

GENERAL MAINTENANCE

1. SHAFT BEARINGS

Grease the bearings after every 50 hours of operation.

2. V-BELTS

The proper belt tension is tight enough that the belts will not slip during operation. Occasionally, belt tension must be readjusted. Do not over-adjust the tension, as this may damage other parts.



ASSEMBLY STEPS

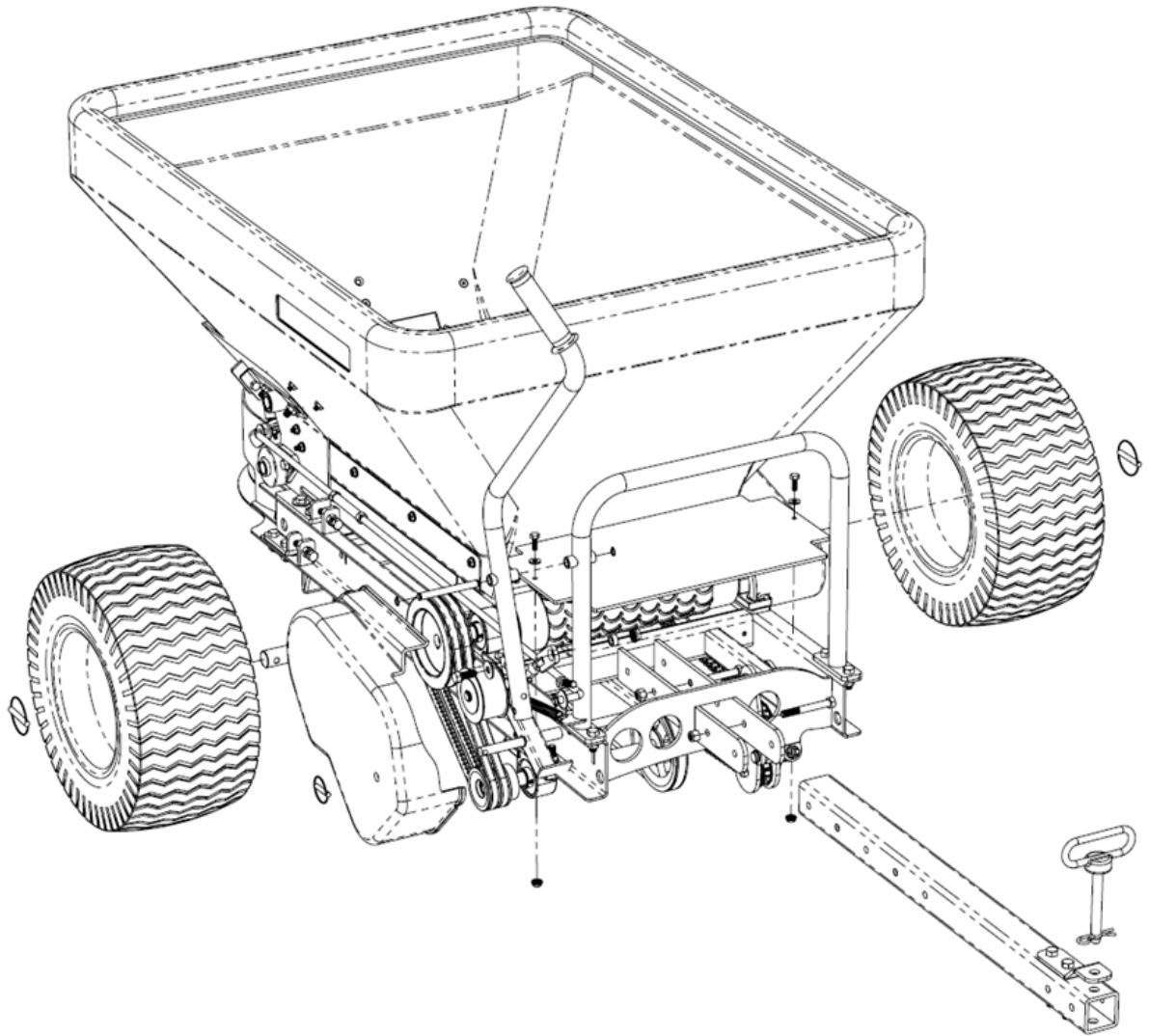

ECO50 Compost Spreader

www.ecolawnapplicator.com

1-866-ECO-LAWN (326-5296)

info@ecolawnapplicator.com

960 Leon-Trepanier,
Sherbrooke, Qc Canada J1G 5J6

